

DL STANDARD ENDWALL

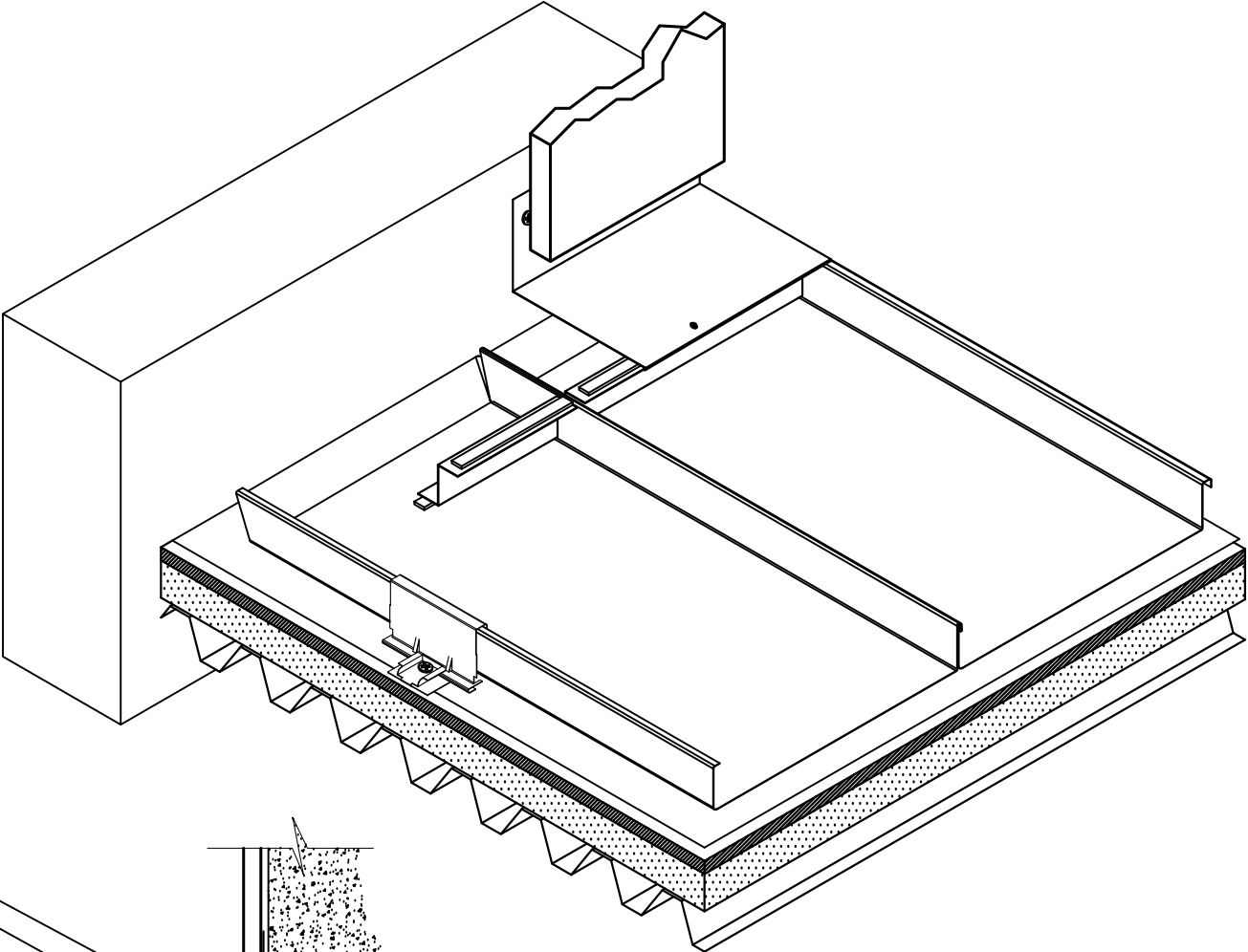

- #963 ARCH. ENDWALL FLASHING
- CAULK SEALED BEND-UP DAM
- SEALANT BETWEEN AND RIVET THROUGH TRIM AND ZEE CLOSURE
- METAL ZEE CLOSURE W/CAULK AROUND GAPS
- EVERLAST METALS DL SERIES
- PANEL CLIP
- LOW PROFILE SCREW
- UNDERLAYMENT
- ROOF STRUCTURE (BY OTHERS)

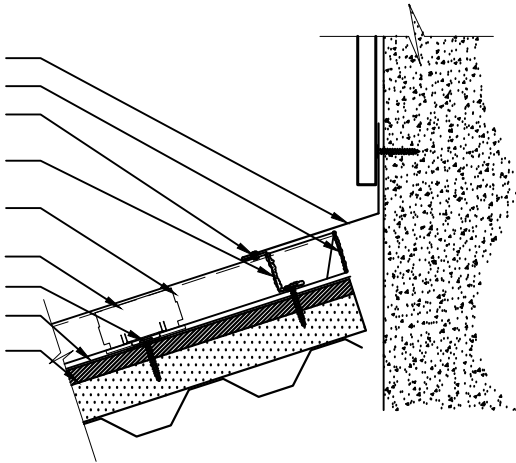

REVISIONS

No.	Date	Rev By:

Scale:

1-1/2"=1'-0"

Proj. No.:

Drawn By: DLD

Date: 4/28/2026

Sheet No.:

A010